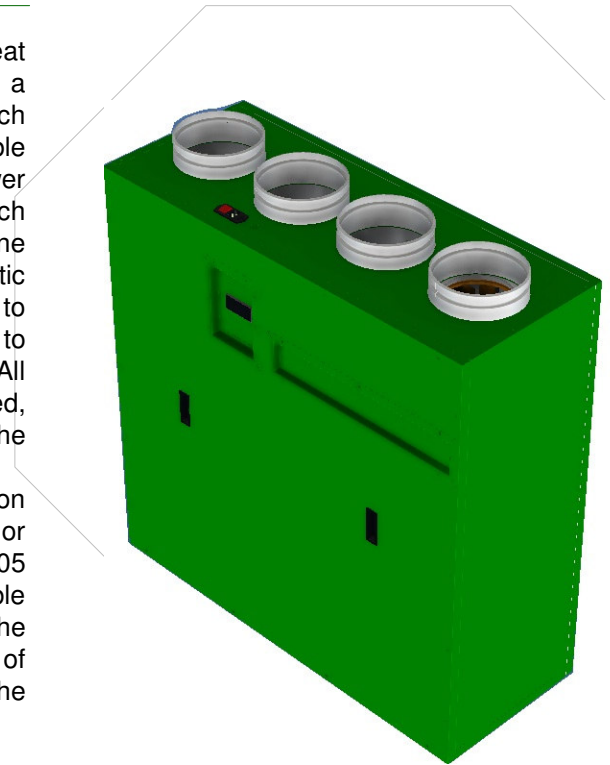

FAN UNIT**MODEL****CODE****ECO500****VCVR50V****DESCRIPTION**

The range consists of a double flow ventilation unit with heat recovery with high efficiency. The machines are equipped with a heat exchanger in counterflow laminar flow polypropylene which guarantees high efficiency (over 90%) in the recovery of sensible heat, centrifugal fans with EC motor paddle back to low power consumption and low noise levels. The body is made of sandwich panels with double pane insulating inner high-density polyurethane or rock wool, which ensures optimal thermal and acoustic performance. Each version has a bypass for the summer-cooling to trigger manual or automatic and shall include antifreeze time to defrost the package if the exchange reached a critical condition. All units, as well as being customizable with all the accessories offered, are complete with electronic board for the management of the operating parameters, controllable in Plug & Play mode.

For this model ECO500, the filters are class F7 high efficiency on both the air flow of extraction that the air flow input. The exterior finish is glossy green color prepainted galvanized and RAL 6005 inside the unit. It's reduced thickness makes it particularly suitable for applications requiring a fixture at wall. This model has the attachments on the same side outside / inside on the upper part of the machine itself and the inspection from the bottom through the removable panel.

**APPLICATIONS**

Units with areas up to about **370 square meters***
Installing at wall **

* With sizing reported in 0.5 vol / h.

** Provide a space for inspection

PREROGATIVE

Small size
By Pass and remote-control
Robustness
Silence

EQUIPMENT

Operating and maintenance
Certificate of warranty
Brackets
Power Cable

OPTIONS

Different types of filters (grease, HEPA, etc.).
External probes of air quality
External pressure probes
Water coils
Post-heating devices

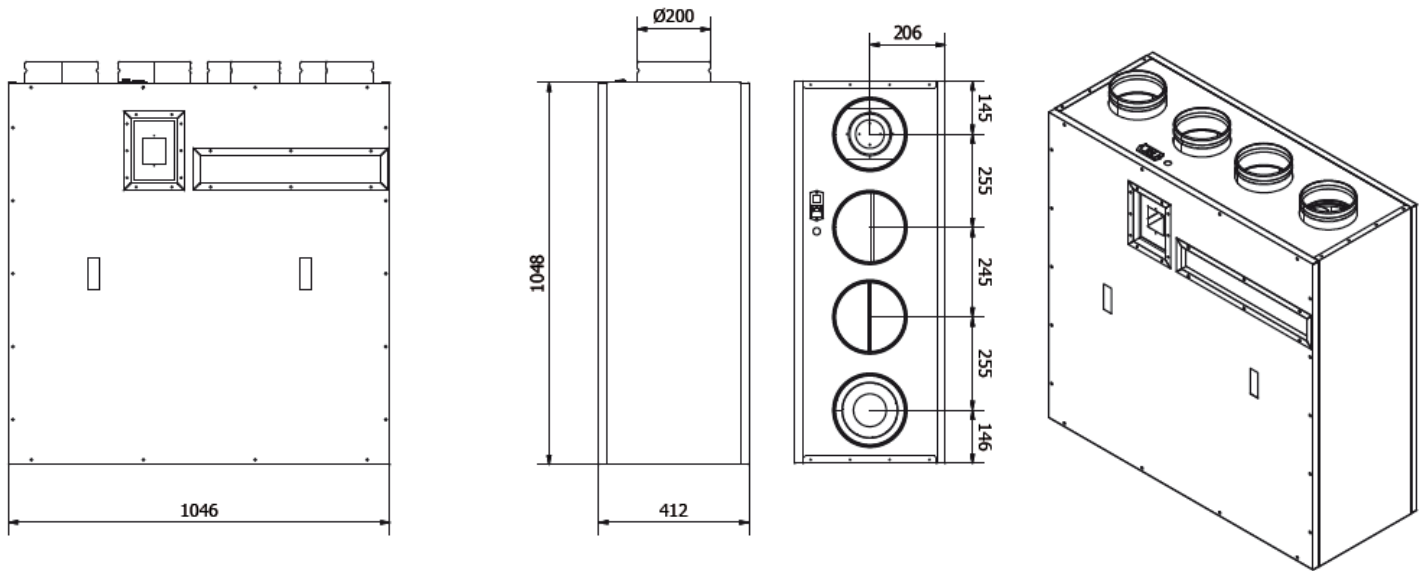
FAN UNIT**MODEL**
ECO500**CODE**
VCVR50V**TECHNICAL SPECIFICATIONS****DATA SHEET****DIMENSIONS**

ECO500	WIDTH	LENGTH	HEIGHT	VENTS INPUTS	SUPPORTS	CONFIGURATION
mm	1050	1050	412	200	100	V1-V2

CHARACTERISTICS

PERFORMANCE		SSC
Air Flow	mc/h	500
Available Pressure	Pa	170
Thermal Efficiency	%	>90%
Voltage	V/phase/Hz	230/M/50-60
Total Maximum Power	W	330W
Sound pressure	dB(A)	49
Class Filter		F7
Electronics		Integrated
Thermoacoustic insulation	mm	23
Weight	kg	77

*measured in free field at 3 m (speed 100) with ducted unit

FILTER CODE

FILF750V

FAN UNIT

MODEL
ECO500

CODE
VCVR50V

CONFIGURATIONS

■ Exhaust
 ■ Fresh Air
 ■ Inlet Air
 ■ Extraction Air

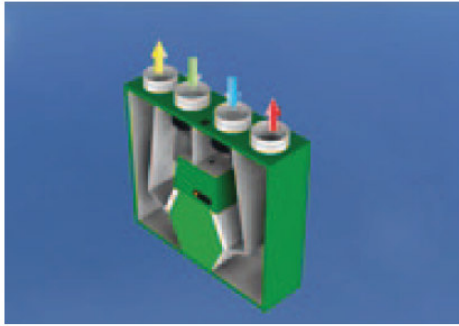

V1

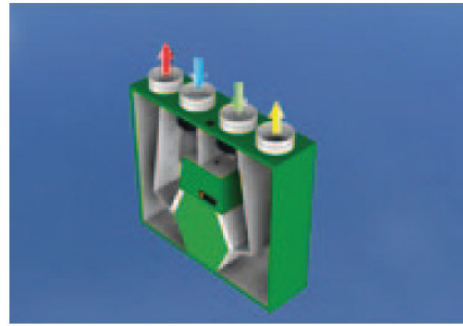

V2

TECHNICAL SPECIFICATIONS

